

INSTALLATION INSTRUCTIONS – T&G PROFILE FLOATING & DIRECT FIX INSTALLATION

FIDDLEBACK ENGINEERED AUSTRALIAN TIMBER RANGE

For our Fiddleback Australian Timber T&G profile we provide important guidelines that must be followed to ensure a quality install. **This product is designed for floating installation or direct fix by professional installers only.** Please read the document as a number of important considerations are noted for a floating installation, the use of professional contractors should ensure a quality installation.

All floating installations require an Acoustic Underlay & Moisture Barrier (MB) system. **Substrate flatness is critical; sub-floor should not exceed 3mm over a 3m radius in all directions. Any hollows or humps need to be assessed and rectified prior to installation.** Please follow manufacturer's guidelines for leveling compound application and drying times. Loose planks, particle board and plywood need to be secure, additional fixings may be required. Do not install during temperature extremes. Whenever possible cover windows & door openings 24 hours prior to install to moderate the interior temperature, reduce excessive heat, and direct UV.

Note: Fiddleback Australian Timber cannot be installed over any form of sub-floor heating. This includes in-slab hydronic heating and any other form of heating blankets or in-screed sub-floor heating. Evaporative Cooling systems must be operated as per system guidelines to avoid a build-up of internal humidity & moisture. Ventilation flows are critical, prolonged moisture exposure will damage the surface of the planks.

Before proceeding with installation site conditions need to be inspected by the installer. Site specific circumstances such proximity to water, river systems and coastal regions along with other climatic extremes will require more complex installations methods and maintenance. Under floor inspections must be conducted before installation whenever possible. **Ensure installers are wearing appropriate personal protective equipment and that the site is well ventilated and protected from excessive heat, direct sunlight, or moisture ingress. Use temporary window coverings if the site is unoccupied or if no coverings exists.** This product is not suitable for installation directly onto a bearer & joist system.

PRE-INSTALLATION REQUIREMENTS

Importantly, a professional contractor should perform the installation. The installation process and method selected is solely the responsibility of the contractor and you must be satisfied that the contractor is qualified to conduct your site installation. Workmanship and method of installation is not covered by the manufacturer's warranty. If you have concerns, immediately contact the retailer or building contractor involved in your project.

At site, please store the product in original cartons placed on a flat, dry area away from any extreme temperatures or moisture.

- 1. The planks must be carefully inspected prior to install to detect any imperfections, do not install planks that contain defects.** If certain planks are displaying slight bow set aside under load to assist with site acclimatisation, these planks can be reused later.
- 2. FAULTY PLANKS SHOULD NOT BE INSTALLED and will not be covered by warranty. A waste factor of 8-10 % is required for length cutting, sorting and visual selection.** If product faults are detected, immediately contact the point of purchase.
- 3. The site area must be clean and free of any contaminants, dust, or other construction / painting activity whilst the installation is in progress.** Make sure you have the necessary floor covering protection material available if further construction is occurring after the installation. Do not use adhesive tape directly on the surface of the planks.

www.preferencefloors.com.au

Adelaide (SA)

t +61 8 8262 2774
sa@preferencefloors.com.au

Brisbane (QLD)

t +61 7 3875 1688
qld@preferencefloors.com.au

Melbourne (VIC)

t +61 3 9794 5111
vic@preferencefloors.com.au

Perth (WA)

t +61 8 9471 7785
wa@preferencefloors.com.au

Sydney (NSW)

t +61 2 9738 1188
sales@preferencefloors.com.au

FLOATING INSTALLATION – Acoustic underlay with attached moisture barrier (PE) film or an acoustic underlay with 200uM builders' plastic (BP) is required. PVA adhesive must be DIN Certified D3/BS EN204 for structural joints.

Use Sika, Mapei, Roberts or similar professional flooring cross-linked adhesives that comply with the D3/BS EN204 formula. Generic PVA's such as Aquadhere any type cannot be used under any circumstances; they are not suitable for gluing structural joints. If the floating option is selected the install performance and workmanship is a matter between buyer and reseller/ installer. Floating installations require a moisture barrier and acoustic membrane on top of all substrates. Concrete slab must be dry, maximum 2.5% and wood-based floors dry, maximum 14 %. **Expansion provisions must be followed to ensure warranty guidelines are compliant.**

1. Place acoustic underlay with PE film & or 200uM BP with underlay on sub-floor & up wall skirt area (>50mm), overlap and tape.
2. Once the planks are selected apply cross linked PVA Adhesive which meets the D3/BS EN 204 specifications to the top of the Tongue profile on both long and short ends. Apply adhesive to the underside of the groove. **Do not use excessive adhesive as it may squeeze onto the plank surface. Only apply adhesive to a small number of planks at a time to avoid curing prior to install.**
3. Floor expansion and contraction requires perimeter expansion of 12 – 15mm for floating installations, this cannot be avoided. **Width areas greater than > 6m and length runs greater than >11m will require installation of expansion and transmission joints to assist the natural movement of the floor. As a guideline allow an extra 1- 2 mm expansion gap for every extra 1m of width over the raft size, (6m x 8m).** Adequate space around heating and service ducts should be created to allow the floor to expand and contract. **Refer Figure 2 & 3. Note: caulking will hinder natural floor movement, it should not be used.**
4. If the client objects to trim inclusions, please keep a record that the client did not wish to include expansion trims. Perimeter expansion guidelines must be followed. Wherever possible, each room should be treated as a separate install, this will assist in reducing floor movement and floor tension for an optimum install.
5. **Large objects such as Kitchen Island benches should not be placed on a floating floor.** The floor planks need to be installed around the perimeter of the Island Bench or under the bench kick boards/fascia to allow for natural floor movement.
6. **First and last plank length should not be less than 300 mm, short end joins on parallel planks should be at least 300 mm in distance from the adjoining plank, Figure 1.** Plan the layout of plank lengths and for visual aspects prior to final fix. This will assist in providing a balanced blend of grade, colour, and joint alignment. For optimum visual impact planks should run in the direction of the longest wall area. Regularly review install alignment.
7. The installer needs to establish a method for pulling the planks tightly together to ensure gapping or bowing does not eventuate during the install process. Methods such as cramping, wedging or ratchet mechanisms are commonly used. The installed plank areas must be weighted to assist in keeping the floor flat & stable. Avoid foot traffic whilst adhesive is curing, refer adhesive instructions.
8. **Cover flooring with adequate protection if construction or painting is still occurring at the site.** The finished floor must be protected from intense direct sunlight. Screens or Blinds must be used to inhibit direct sun. Items such as rugs and mats should not be introduced until the floor has been able to acclimatise in its environment, this will take approx. 8 weeks.

Figure 1. Spacing.

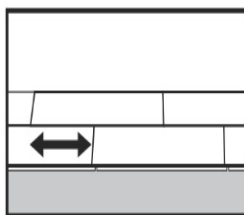

Figure 2. Cut outs.

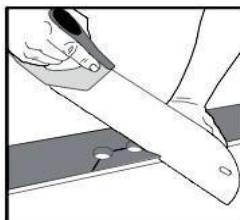

Figure 3. Cuts & glue



**DIRECT ADHESIVE FIX INSTALLATION FULL TROWEL SPREAD
ONLY EXPERIENCED INSTALL CONTRACTORS SHOULD USE THIS METHOD OF INSTALLATION**

Note: **Our 13mm thickness is not suitable for direct fix over a concrete slab, no warranty will apply.**

It is critical that individual plank inspection occurs prior to permanent fix, no warranty will apply for defective planks if they are installed. **If in doubt leave it out and set aside for review with your supplier.**

1. Substrate materials such as structural Plywood and P/Board should be flat, dry (<14%) free of moisture ingress and secure. **Concrete Slab must be dry approx. 2.5%** prior to installation. **Substrate flatness is critical; sub-floor should not exceed 3mm over a 3m radius in all directions.** For concrete slabs, any hollows or humps must be levelled prior to installation. Please follow manufacturer's guidelines for leveling compound application and drying times. **Do not install if levelling compound is not dry.**
2. All wood based sub-floor edges and surfaces must be lightly sanded to ensure flatness, particularly at the joints. Surface area must be sanded to remove any foreign substances such as waxes or paint. This will aid the adhesion process.
3. Inspect all planks carefully prior to install to detect any imperfections. **FAULTY PLANKS SHOULD NOT BE INSTALLED** and will not be covered by warranty provisions. If certain planks are displaying slight bow or twist set aside under load to assist with site acclimatisation, these planks can be recycled into the install later. If further assembly issues arise, please contact point of purchase immediately, **do not install defective planks. If in doubt stop and follow up immediately to resolve the issue.**
4. Whenever possible cover windows & door openings 24 hours prior to install to moderate the interior temperature, reduce excessive heat, and direct UV. Do not install in during temperature extremes, always follow adhesive manufacturers guidelines.
5. **An optimum install requires full trowel adhesive using a minimum 4mm square notched trowel.** A recognised wood flooring adhesive & moisture barrier such as Sika, Mapei or similar system is required **(use same brand for both). Refer, Pictures 1 & 2.** The planks must be weighted to assist with high bond outcomes. Avoid foot traffic during the adhesive curing time. **Note: Bead Gluing is not considered full contact bonding and is not covered by our warranty. For concrete slab installs, 3 in 1 adhesive with 'claimed' moisture barrier attributes must be applied with a compatible moisture barrier to comply with our warranty. No warranty applies without proof of an additional moisture barrier for the concrete slab. Keep photographic files to support your workmanship methods and slab testing data.**
6. To optimise structural and visual performance, first and last plank **length should not be less than 300 mm and short end joins on parallel planks should be at least 300 mm lengthways in distance from the adjoining plank. Refer, Figure1.**
7. Carefully plan the layout of plank lengths and visual aspects / knots prior to final fix. This will assist in providing a balanced blend of grade, colour, and joint alignment. It is always a smart idea to make sure the owner's expectations are consistent with the installer's layout plan. Heavily featured planks can always be used under cabinetry or similar less obvious locations.
8. For optimum visual impact planks should run lengthways in the direction of the longest wall area, including hallways.
9. **Large objects such as Kitchen Island benches can be installed onto a Direct Fixed floor. Please make sure the installed floor is well protected if other trades are still to complete their fit outs.**
10. On Plywood and P/Board, secret nailing at 200-300mm intervals can assist with alignment issues and adhesion in difficult areas.
11. Perimeter expansion will vary from site to site. The installer will need to assess perimeter expansion opportunities to maximize the natural movement of the floor for expansion and contraction especially around door thresholds, service ducts and heating pipes. If required, a flexible caulking compound to a maximum of 3-5mm is suitable with direct fix elastomeric adhesive installations.

DIRECT ADHESIVE FIX INSTALLATION CONTINUED

Picture 1. Full Trowel



Picture 2. Plank Bonding



Picture 3. Clean Spills



AUSTRALIAN TIMBER FLOOR CARE & MAINTENANCE

- **Do not use a steam mop or wet mopping to clean the floor.** Static or absorbent towelling mops should be used for all floor surfaces. When incidental spills occur simply wipe dry with an absorbent cloth and use a light bristle broom for daily cleaning. **Do not use generic supermarket floor cleaning solutions on the floor,** we recommend professional floor care products such as **Bona** or **Loba**. **Spray Mop Kits and refill floor cleaning** products are readily available online or through popular retail outlets in Australia & NZ.
- For installations requiring skirting-boards or scotia, these items should be installed by fixing them directly to the adjacent wall. **Do not fix the skirting board or scotia trim directly into the timber planks,** this will stop the floor from moving freely and create floor tension leading to floor buckling (speed bumps). If you intend to keep the original skirting undercutting existing skirting or door jambs is a common method to accommodate the necessary perimeter expansion.
- The floor must be protected from intense direct sunlight. Screens, blinds, or window tinting must be used to inhibit direct sun. **Large rugs and mats should not be introduced until the floor has acclimatised in its environment; this will take approx. 8 weeks.**
- Do not place office chairs or castor wheel chairs directly on the surface of the floor, a rigid plastic chair protector, or similar must be placed on the surface to stop damage from chair movement and grit build up.
- Place felt or similar floor protection pads under all kitchen or occasional furniture & chairs. This will reduce general wear & tear.
- **For any above surface heating or cooling systems, they must be operated to match the performance guidelines for engineered Australian Timber flooring. Evaporative cooling systems must be installed and operated with adequate ventilation flow as per system recommendations. Poor use of evaporative cooling systems will create high internal humidity and residue moisture within the home. Surface checking, cupping, or gapping may occur as a direct result of insufficient air flow within the interior space.**
- **An expanded Australian Timber floor care guide is available for easy reading or download from our website.**

Disclaimer: Preference Floors has used its reasonable endeavours to ensure the accuracy and reliability of the information contained herein and, to the extent permitted by law, will not be liable for any inaccuracies, omissions, or errors in this information nor for any actions taken in reliance on this information. Products must be installed in accordance with relevant installation recommendations and industry best practices. © Homemirus Pty Ltd trading as Preference Floors. Head Office 02 97381188.

www.preferencefloors.com.au

Adelaide (SA)

t +61 8 8262 2774
sa@preferencefloors.com.au

Brisbane (QLD)

t +61 7 3875 1688
qld@preferencefloors.com.au

Melbourne (VIC)

t +61 3 9794 5111
vic@preferencefloors.com.au

Perth (WA)

t +61 8 9471 7785
wa@preferencefloors.com.au

Sydney (NSW)

t +61 2 9738 1188
sales@preferencefloors.com.au